



FEATURES:

- Surface mounted LED aluminium profile
- Stainless Steel Suspended mounting kit

Body

- Made of extruded aluminium
- Powder coated finish (Option)
- White, Black, Grey & Silver

Diffuser

- Prismatic or Opal Polycarbonate

Others

- ◆ Stainless steel mounting clip
- ◆ Built in LED drive (Meanwell)
- ◆ High quality SMD LED chip
- ◆ Heat resistant and solid conduct wiring
- ◆ Ideal for interior lighting
- ◆ European standard of EN 60598

Available:



IP44



IP65 Version on request

BRPG/PS10270/(**)

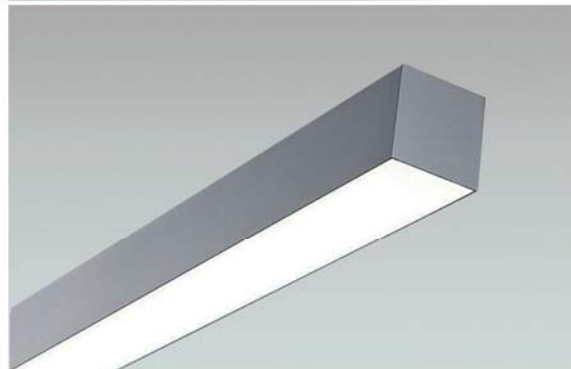

Customade (Max. Length 2500mm)

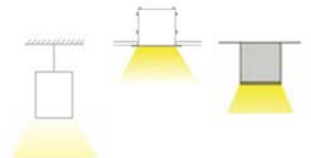
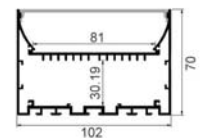

Model No.	BRPG/PS10270/500	BRPG/PS10270/1000	BRPG/PS10270/1500	BRPG/PS10270/2500
Size	L500xW102xH70mm	L1000xW102xH70mm	L1500xW102xH70mm	L2500xW102xH70mm
Power	10 - 30W	20 - 60W	30 - 90W	50 - 150W
Type of LED	SMD2835 / 5730 / 5050	SMD2835 / 5730 / 5050	SMD2835 / 5730 / 5050	SMD2835 / 5730 / 5050
Luminous Flux	120LM/W	120LM/W	120LM/W	120LM/W
Color Temp.	2700-6500K	2700-6500K	2700-6500K	2700-6500K
Voltage	AC 100-240V	AC 100-240V	AC 100-240V	AC 100-240V
Power Factor	0.95	0.95	0.95	0.95
Beam Angle	110°	110°	110°	110°
CRI	>80	>80	>80	>80
Working Temp.	-20-40°C	-20-40°C	-20-40°C	-20-40°C
Mounting Method	Surface / Suspended / Recessed / Wall			
Size	(Customade Size & Wattage on request)			
Life	50000Hrs			

ORDER CODE

**PG

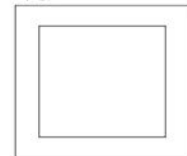

**PS



Aluminium Profile



Suspended and surface installation kit for one lamp for single run and continuous run



Recess. installation kit for one lamp for single run and continuous run



Plastic end cap



Metal clip

ANGLE

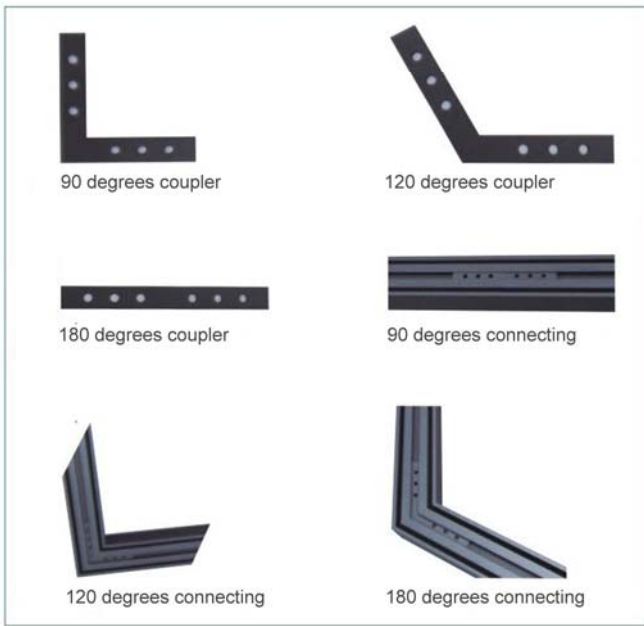

LS3360-(**)

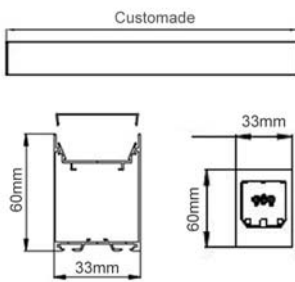

LS4067-(**)

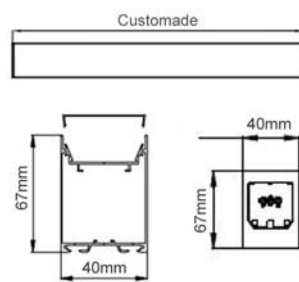

BRAP5532-(**)

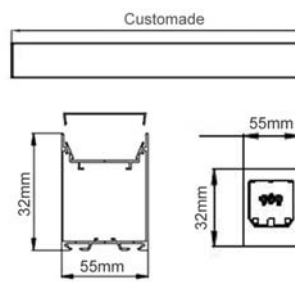

BRAP7676-(**)

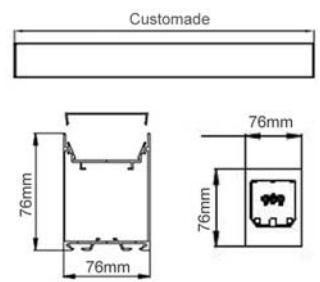

PHOTOMETRIC DATA

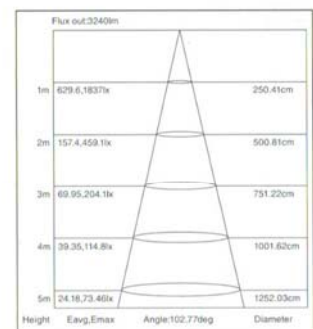
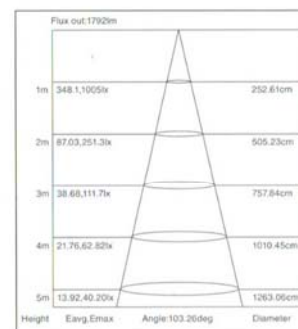
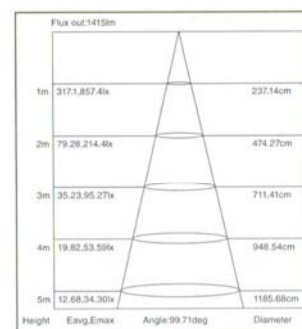
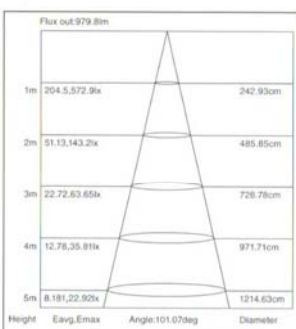
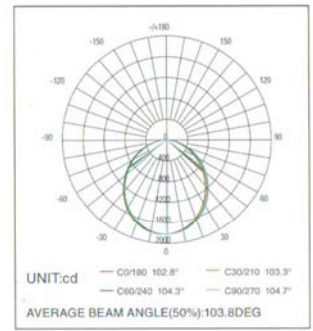
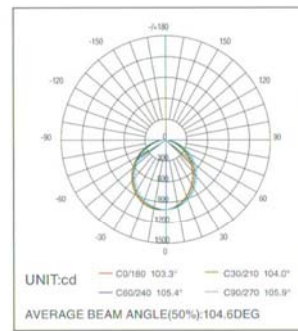
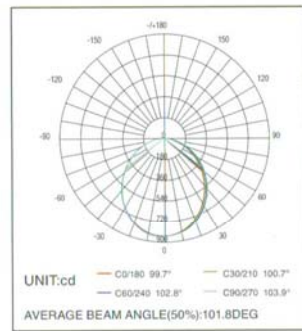
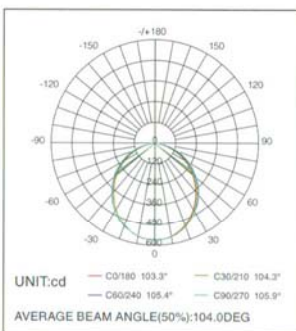

ORDER CODE: A1



ORDER CODE: A2

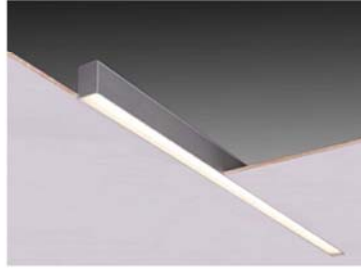

ORDER CODE: A3

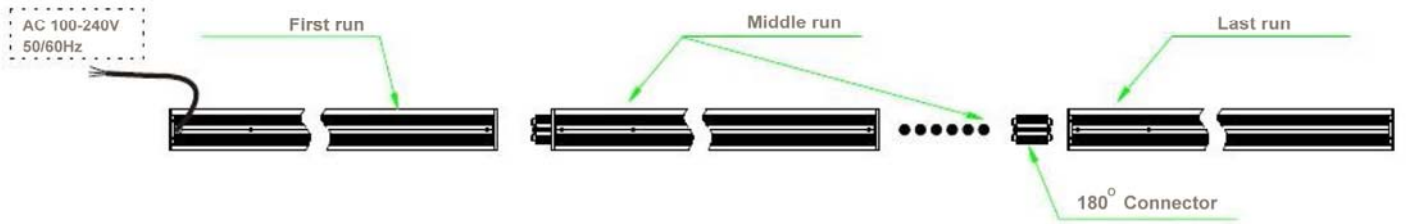
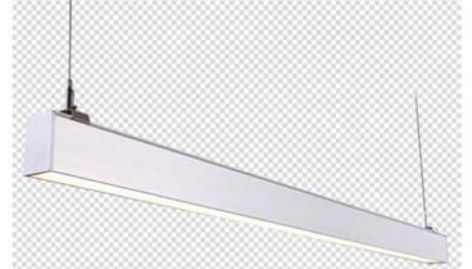

PHOTOMETRIC DATA:

LUMINOUS INTENSITY DISTRIBUTION DIAGRAM

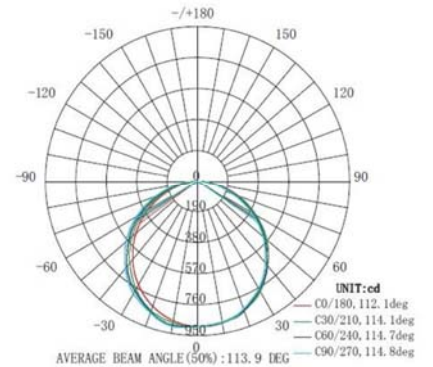
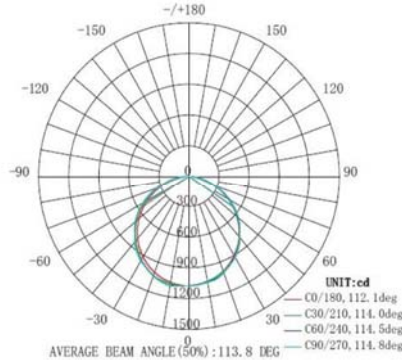
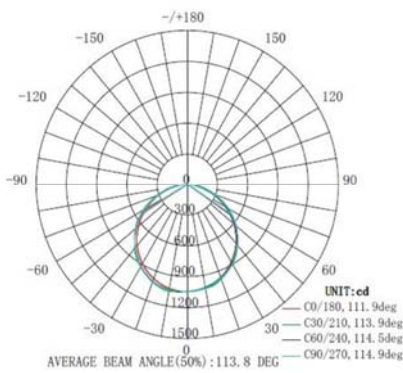

Average Illuminance Figure

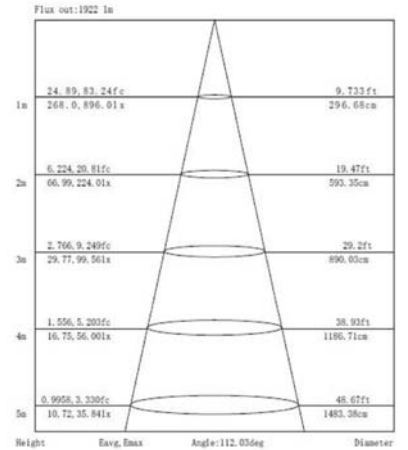
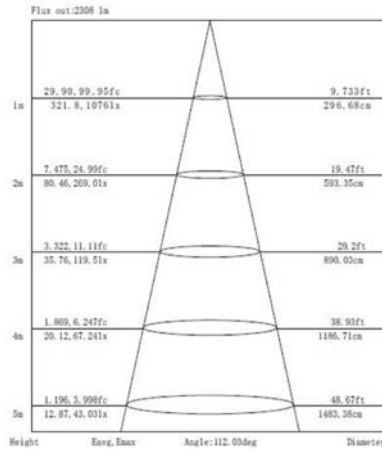
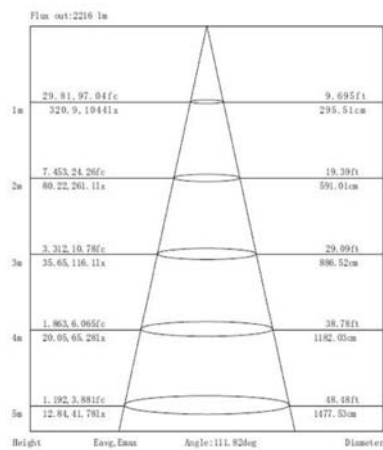

PENDANT DIAGRAM



Step1: Main body installation: profile + power + source + cover + end cap

Step2: Installation of canopy

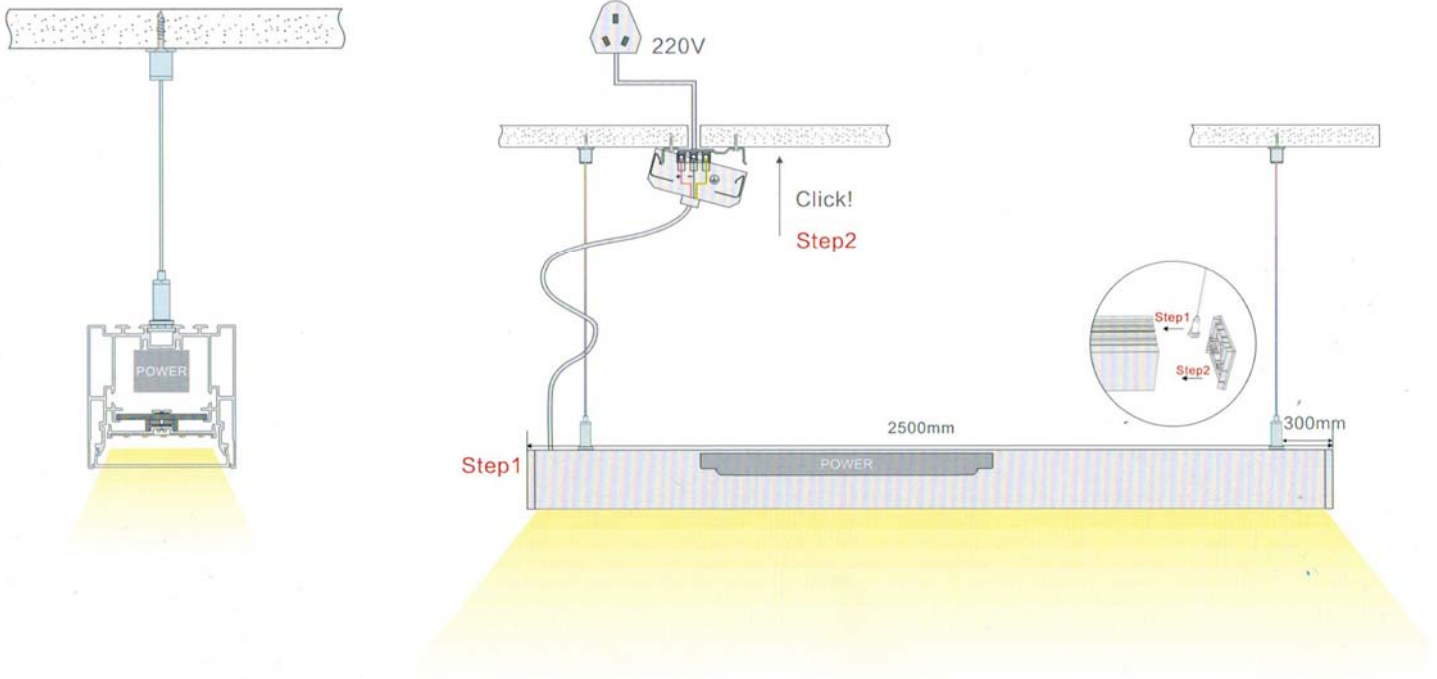

RECESSED MOUNTED DIAGRAM



Step1: Installation of main profile + power supply + end cap

Step2: Embedded installation

Step3: Install light source + cover

Step4: Paint

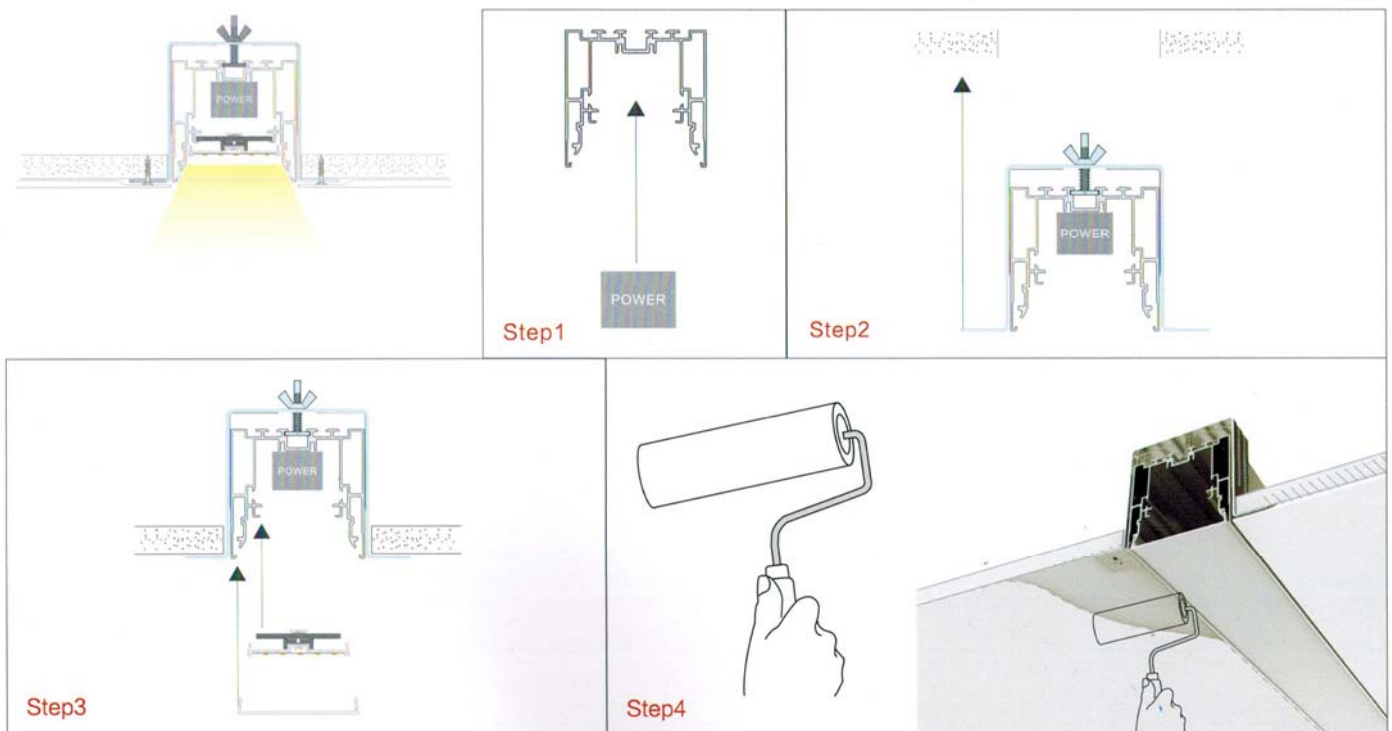

SURFACE / WALL MOUNTED DIAGRAM



Step1: Profile fixed: profile + power+end cap

Step2: Install light source + cover

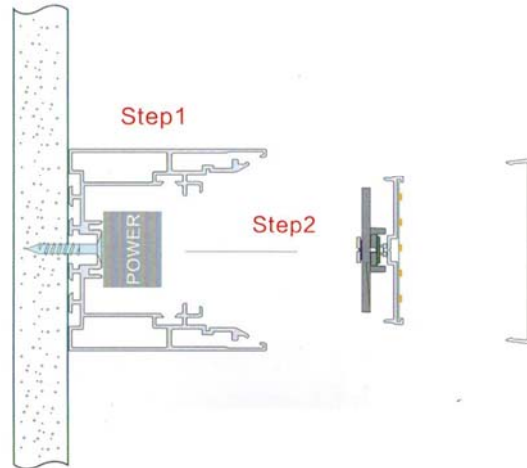
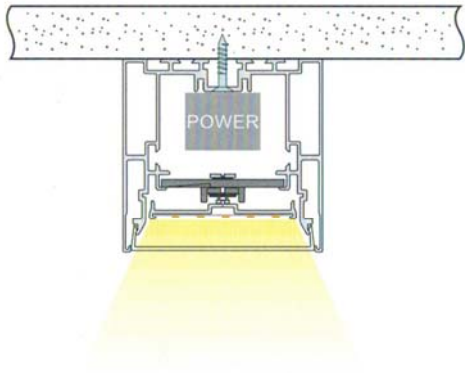

WALL MOUNTED DIAGRAM



Step1: Body installation;Profile+driver+source+end cap+cover

Step2: Fixed roof/wall hanging clamp

Step3: Install profile body

