



FEATURES:

- Surface mounted LED aluminium profile
- Stainless Steel Suspended mounting kit

Body

- Made of extruded aluminium
- Powder coated finish (Option)
- White, Black, Grey & Silver

Diffuser

- Prismatic or Opal Polycarbonate

Others

- ◆ Stainless steel mounting clip
- ◆ Built in LED drive (Meanwell)
- ◆ High quality SMD LED chip
- ◆ Heat resistant and solid conduct wiring
- ◆ Ideal for interior lighting
- ◆ European standard of EN 60598

Available:



IP44



IP65 Version on request

LS7977/1200-()**



Customade (Max. Length 3000mm)

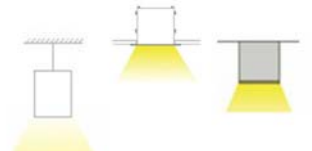
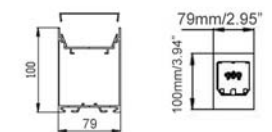

Model No.	LS7977/600	LS7977/600	LS7977/1200	LS7977(**)
Size	L600xW79xH100mm	L600xW79xH100mm	L1200xW79xH100mm	L1500xW79xH100mm
Power	20W	30W	40W	50W / 60W
Type of LED	SMD2835 108Pcs	SMD2835 162Pcs	SMD2835 216Pcs	SMD2835 288Pcs
Luminous Flux	120LM/W	120LM/W	120LM/W	120LM/W
Color Temp.	2700-6500K	2700-6500K	2700-6500K	2700-6500K
Voltage	AC 100-240V	AC 100-240V	AC 100-240V	AC 100-240V
Power Factor	0.95	0.95	0.95	0.95
Beam Angle	110°	110°	110°	110°
CRI	>80	>80	>80	>80
Working Temp.	-20-40°C	-20-40°C	-20-40°C	-20-40°C
Mounting Method		Surface / Suspended / Recessed / Wall		
Size		(Customade Size & Wattage on request)		
Life		50000Hrs		

WALL BRACKET (WL)

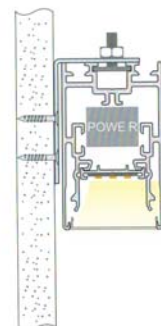

Suspendent installation kit for one lamp for single run and continuous run



Surface installation kit for one lamp for single run and continuous run



Recessed installation kit for one lamp for single run and continuous run



Connector for connecting one lamp to next one for continuous run



LS3360-(**)

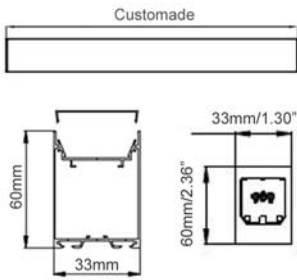

LS4067-(**)

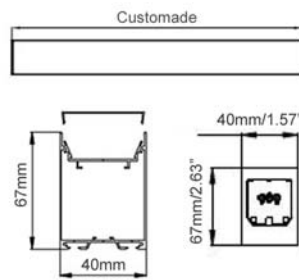

LS5470-(**)

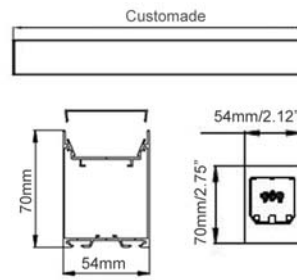

LS10570-(**)

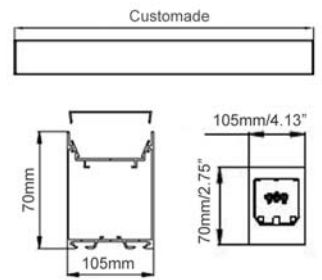

PHOTOMETRIC DATA

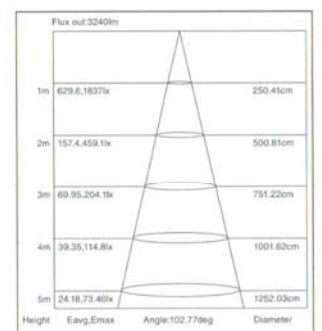
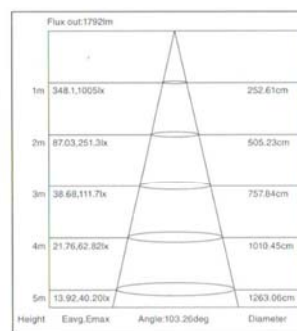
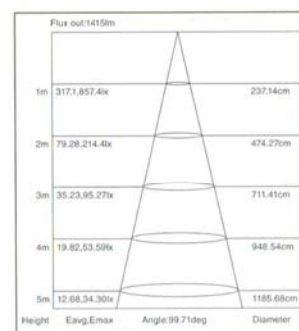
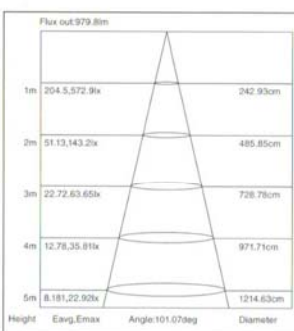
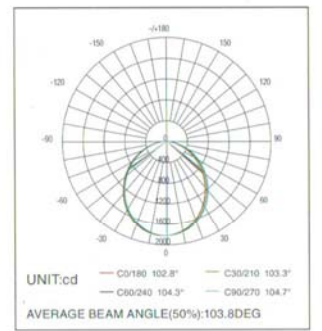
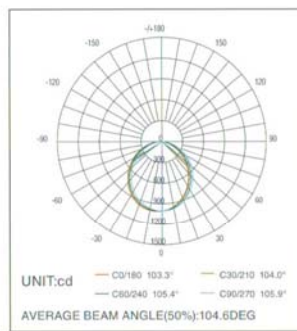
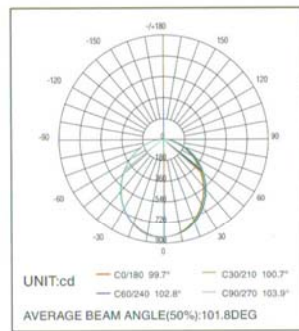
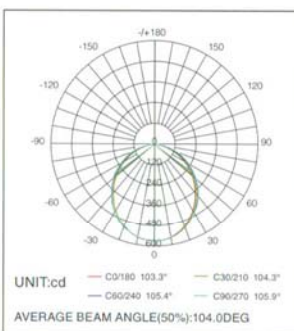

ORDER CODE: A1



ORDER CODE: A2

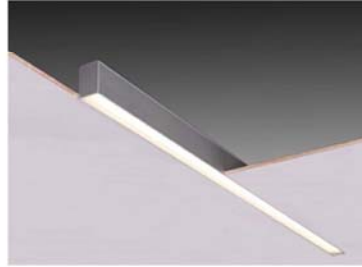

ORDER CODE: A3

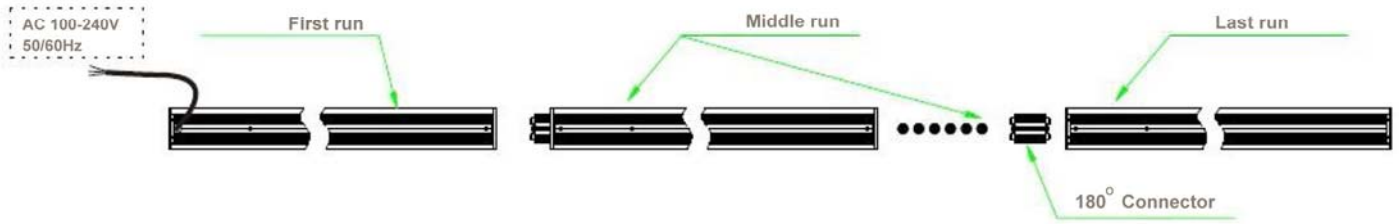
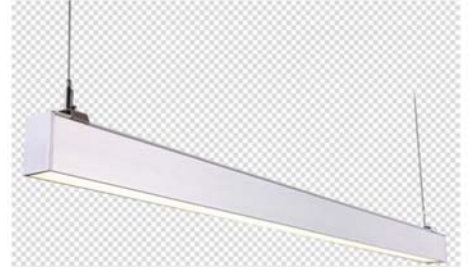

PHOTOMETRIC DATA:

LUMINOUS INTENSITY DISTRIBUTION DIAGRAM

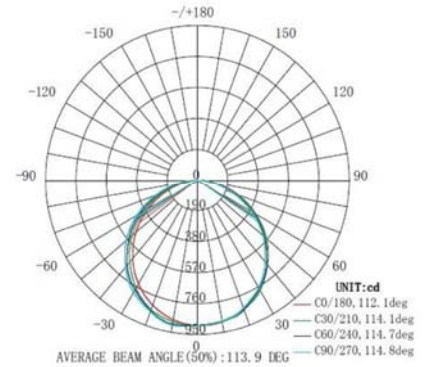
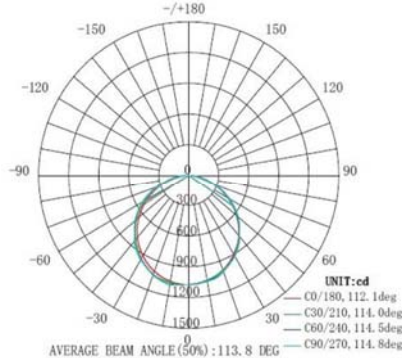
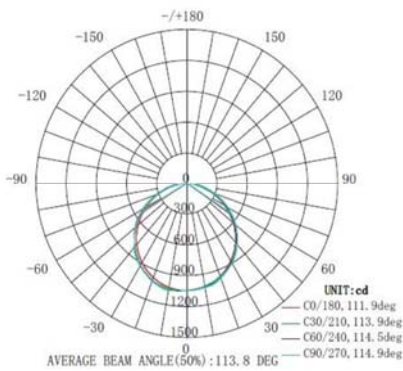

Average Illuminance Figure

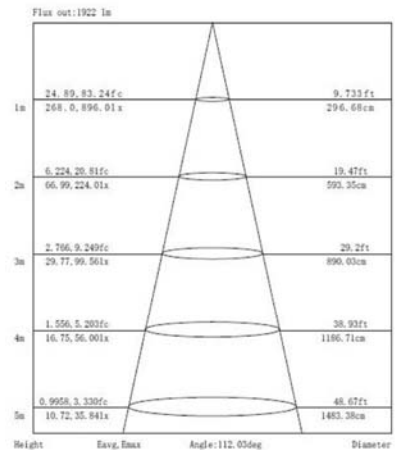
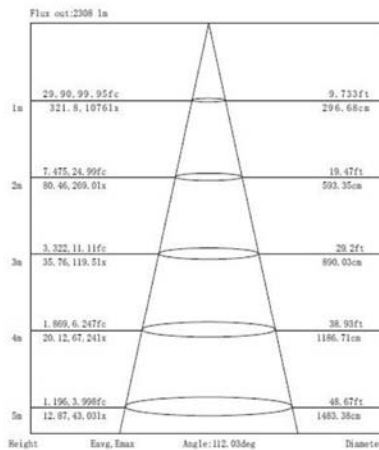
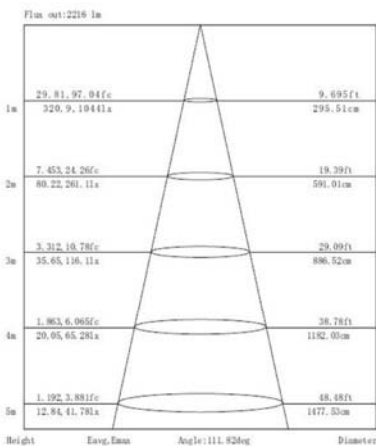

PENDANT DIAGRAM



Step1: Main body installation: profile + power + source + cover + end cap

Step2: Installation of canopy

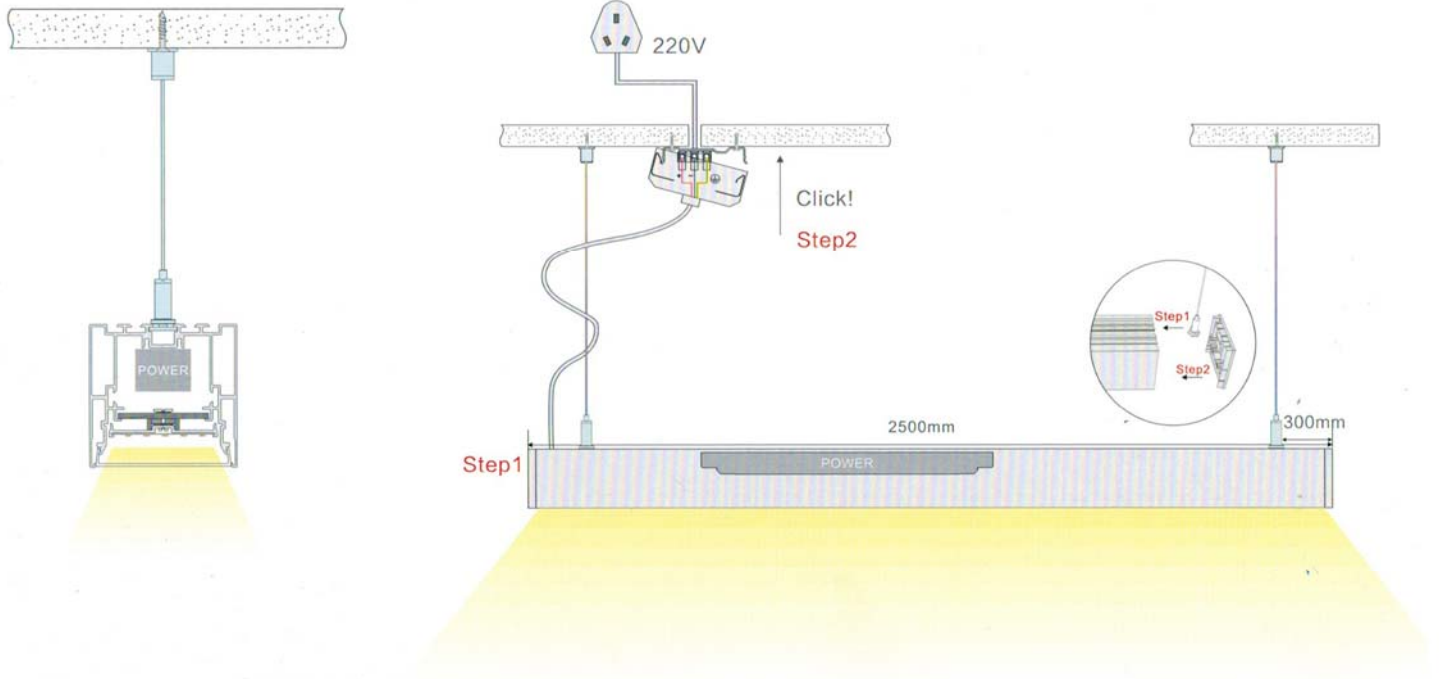

RECESSED MOUNTED DIAGRAM



Step1: Installation of main profile + power supply + end cap

Step2: Embedded installation

Step3: Install light source + cover

Step4: Paint

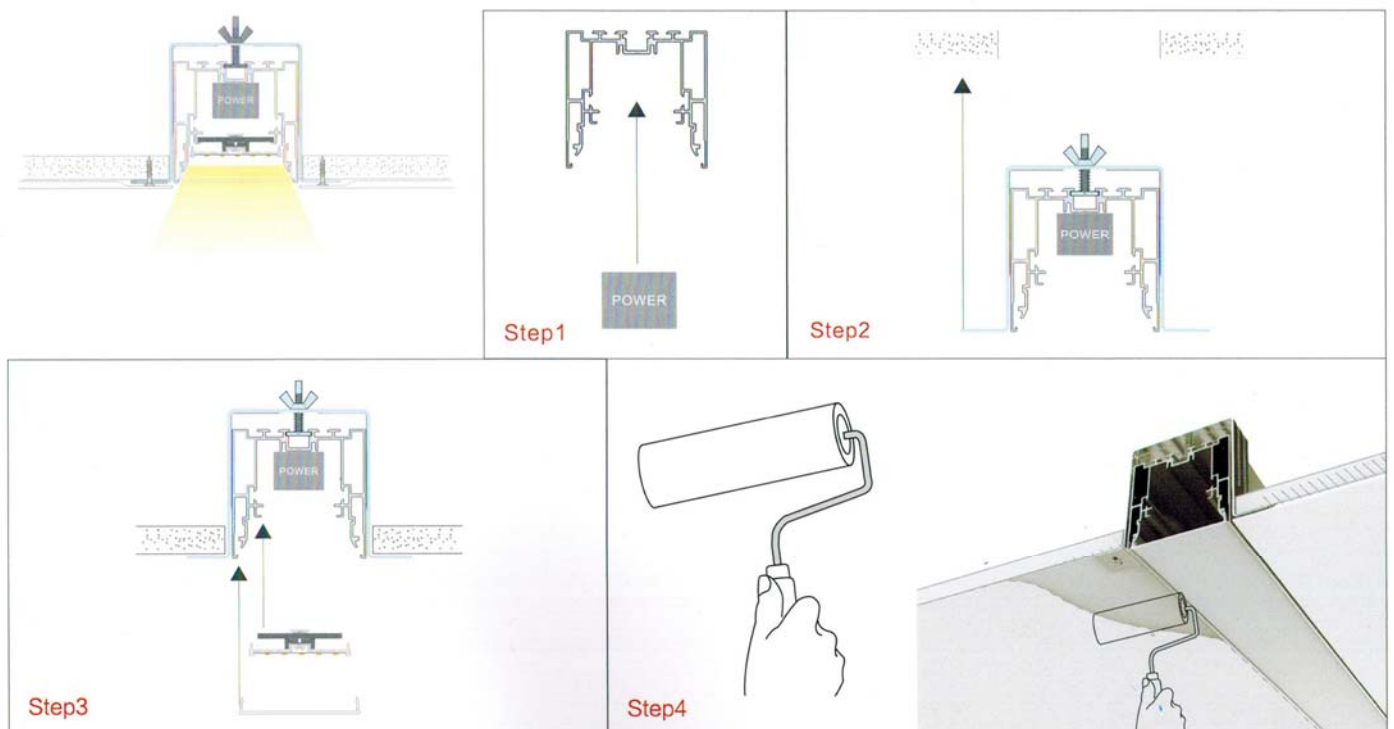

SURFACE / WALL MOUNTED DIAGRAM



Step1: Profile fixed: profile + power+end cap

Step2: Install light source + cover

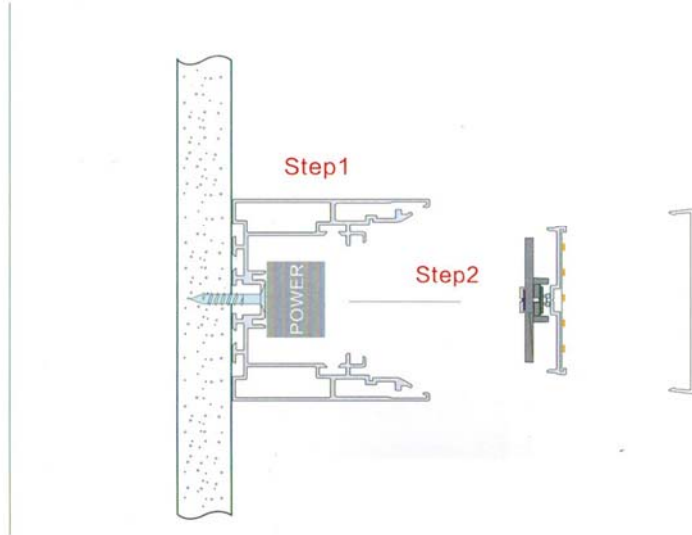
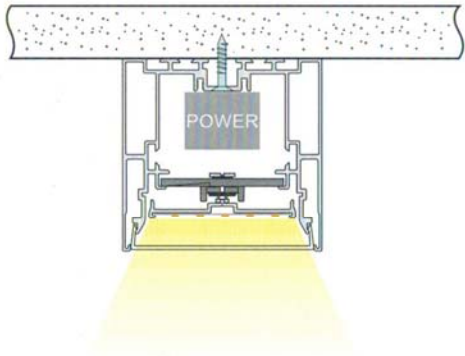

WALL MOUNTED DIAGRAM



Step1: Body installation; Profile+driver+source+end cap+cover

Step2: Fixed roof/wall hanging clamp

Step3: Install profile body

